

130 Series servo motor

⊙ INSTALLATION DIMENSION

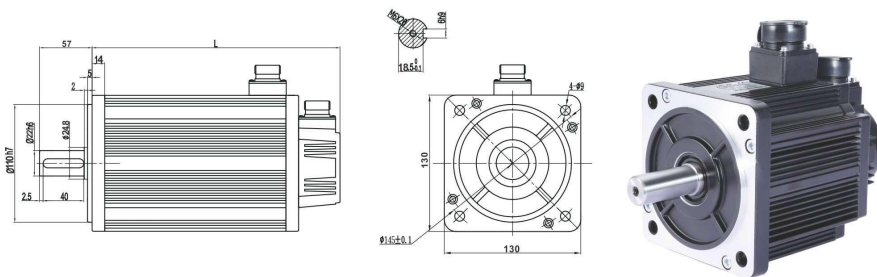

⊙ SPECIFICATIONS

Motor model	130SL-M040 25LB(□)	130SL-M050 25LB(□)	130SL-M060 25LB(□)	130SL-M077 25LB(□)	130SL-M100 10LB(□)	130SL-M100 15LB(□)	130SL-M100 25LB(□)	130SL-M150 15LB(□)	130SL-M150 25LB(□)	
Rated power(kW)	1	1.3	1.5	2	1	1.5	2.6	2.3	3.8	
Rate voltage (V)	220	220	220	220	220	220	220	220	220	
Rated current (A)	4	5	6	7.5	4.5	6	10	9.5	13.5	
Rated speed (RPM)	2500	2500	2500	2500	1000	1500	2500	1500	2500	
Rated torque (N.m)	4	5	6	7.7	10	10	10	15	15	
Peak torque (N.m)	12	15	18	22	20	25	25	30	30	
Voltage Constant (v/1000r/min)	72	68	65	68	140	103	70	114	67	
Torque Coefficient (N.m/A)	1	1	1	1.03	2.2	1.67	1	1.58	1.11	
Rotor inertia (kg. M2)	0.85×10^{-3}	1.06×10^{-3}	1.26×10^{-3}	1.53×10^{-3}	1.94×10^{-3}	1.94×10^{-3}	1.94×10^{-3}	2.77×10^{-3}	2.77×10^{-3}	
Line-line Resistance (Ω)	2.76	1.84	1.21	1.01	2.7	1.5	0.73	1.1	0.49	
Line-line Inductance (mH)	6.42	4.9	3.87	2.94	8.8	4.37	2.45	4.45	1.68	
Electrical time-constant (MS)	2.32	2.66	3.26	3.8	3.26	2.91	3.36	4.05	3.43	
Weight (kg)	6.2	6.6	7.4	8.3	10.2	10.2	9.8	12.6	11.7	
Insulation Class	Class F									
Safety Class	IP65									
Environment	Environmental temperature: -20 ° C~+50 ° C Environmental Humidity: Relative humidity<90% (non frost condition)									
	L	166	171	179	192	213	213	209	241	231
Motor length(mm)	L1	223	228	236	249	294	294	290	322	312
	L2	236	241	249	262	283	283	279	311	301

L1:With Permanent magnet brake L2:With Electromagnetic brake